

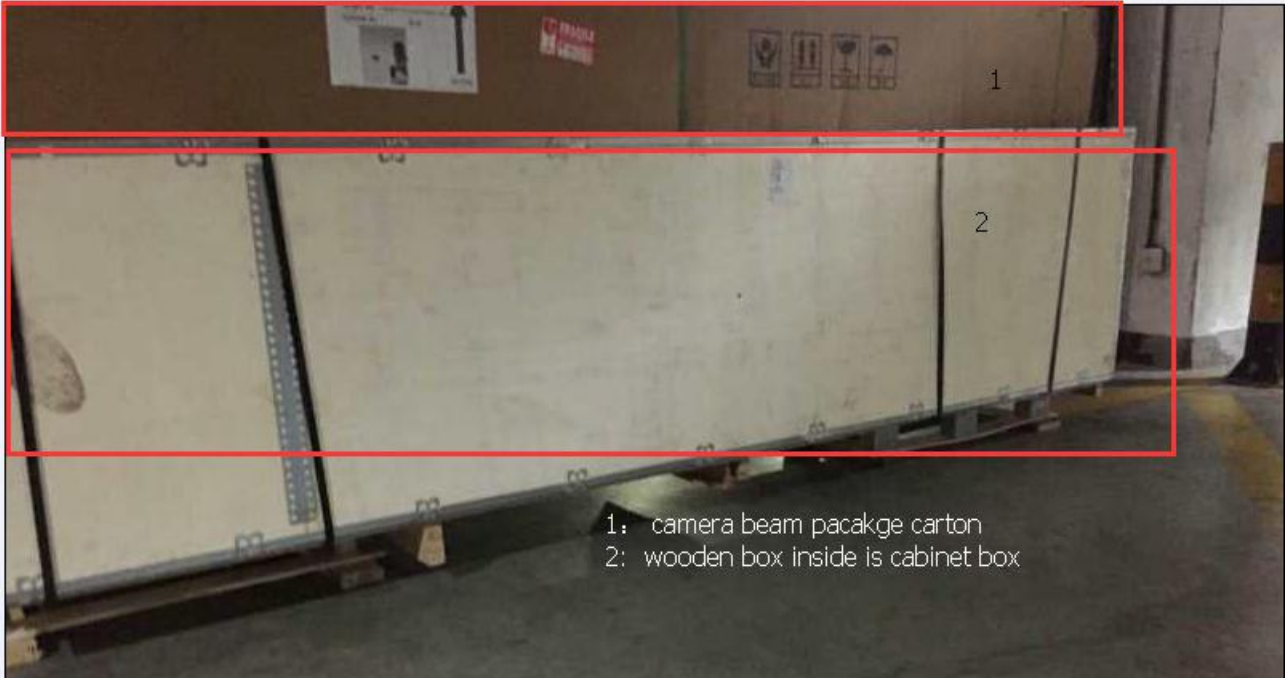

3D wheel alignment Heavy Iron Installation

Part 1: Wheel alignment cabinet assemble 四轮定位仪机柜组装

You will get two packages for your order, one is wooden box and another is carton see picture 1-1 一台定位仪合计两个包装，一个木箱包装，一个纸箱包装



picture 1-1

1st: kindly open the upside shell of wooden box first and remove all the parts inside just keep the cabinet box, SEE PICTURE 1-2 and 1-3

打开木箱上盖，将里面所有配件全部移出来仅保留机柜本体



Picture 1-2



picture 1-3

2nd: kindly revert whole cabinet to another side: the black curtain side be attention, during reverting, please make sure do not hurt the cabinet painting please, and find the top 2pcs screw of curtain and remove it see picture 2-1 将整个机柜翻转180度，黑色帘朝上，注意翻转过程中，不要破坏喷漆看最上端，有两个螺丝固定钢琴帘的看图

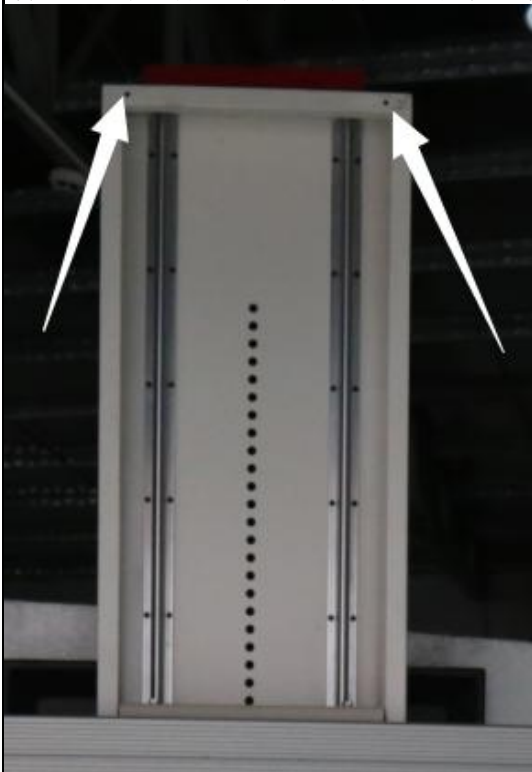

picture 2-1

kindly keep the upside curtain screws safe, need install back after finished 3rd step

3rd: after remove the upside curtain screw, move curtain to downside and you will find the heavy iron unit picture 3-1, the heavy iron unit used for beam up and down, and you will find the heavy iron unit was locked by two long screw also, the reason we locked it because avoiding the heavy iron unit will collision the beam's rail during transport, so we fixed it in advance but you need to release it when arrive your workshop otherwise the beam can not up and down by controller ,**video of remove away the long screw available ask me to sent you through whatsapp if you need**

钢琴帘上端的两个螺丝移走后，将钢琴帘下移，你会发现一个配重铁，看图，配重铁用来调节横梁上下移动，并且你会发现这个配重铁是用两个长的螺丝固定住的，我们固定他的原因是担心在运输过程中配重铁会撞击横梁轨道，货物到了您店里以后，您需要将配重铁的螺丝去掉即可，我有拆掉两个长螺丝的视频，如果需要 管我要

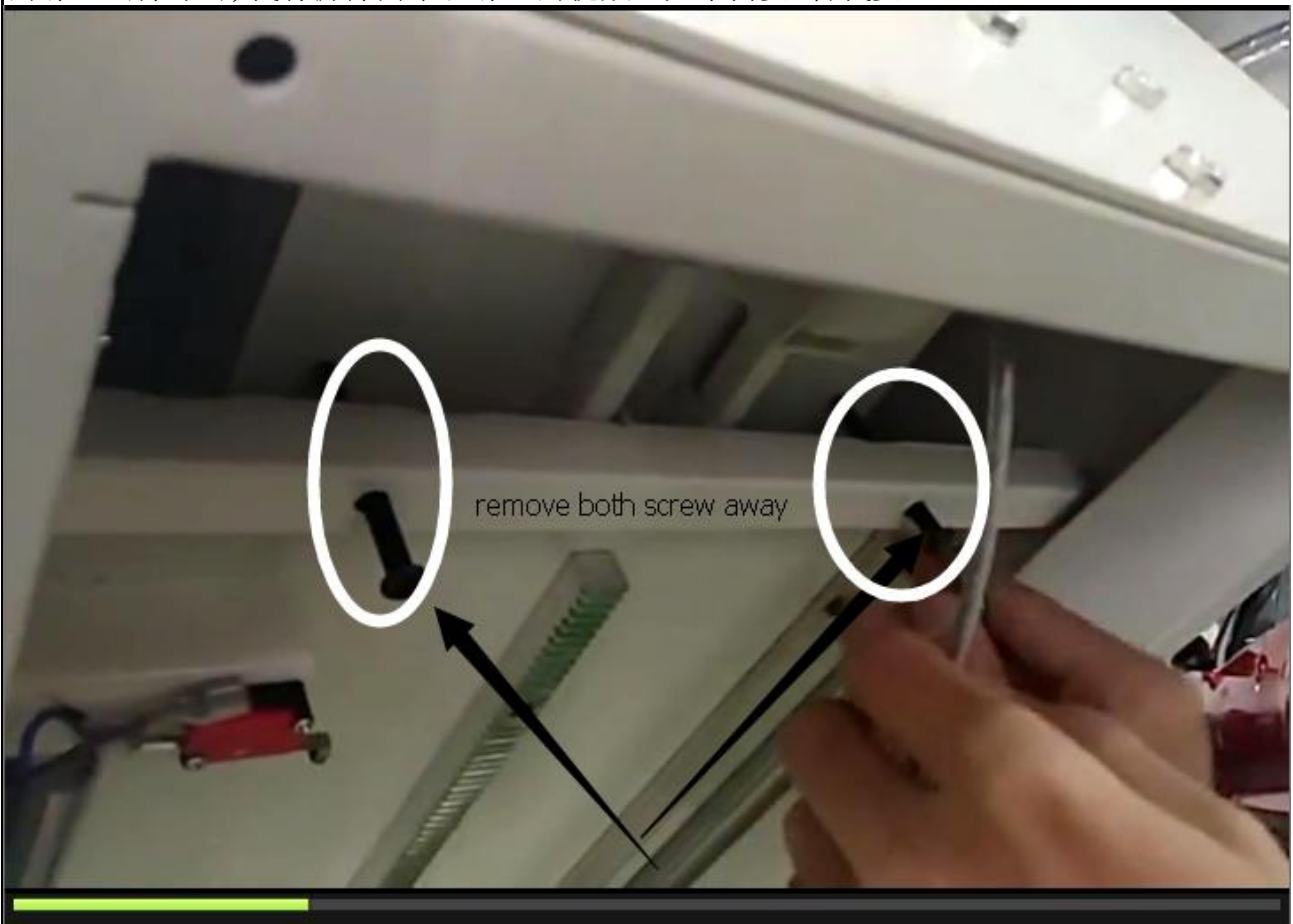

picture 3-1

4th: remove away the 3-1's two long screw , and recover the curtain with upside two screw, revert the cabinet box to 180 degree again and finished
将两个长螺丝移走，然后将钢琴帘重新安装回去，再将机柜翻转180度

5th: how to install other parts to cabinet and line's connection kindly check the video through: http://www.hairuida.cn/en/h-nd-j-104-4_12.html

其他的安装，烦请见视频安装指导: http://www.hairuida.cn/en/h-nd-j-104-4_12.html

6th: distance from camera to middle of turntable ,which installed on front of alignment lift we request 2.2 meters, destails kindly ask me to request the distance request between alignment and lift和举升机距离要求，联系我发送文件